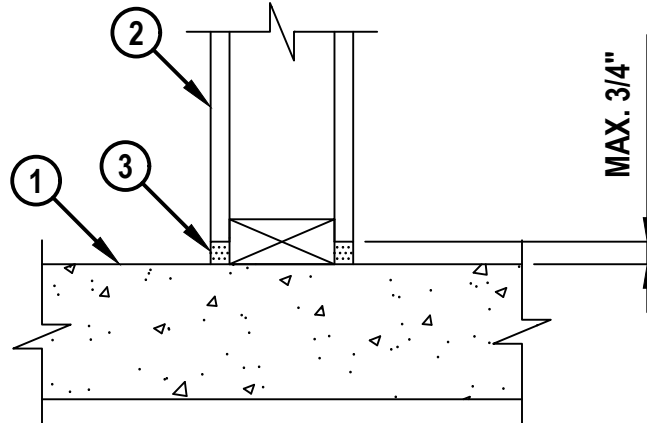

BOTTOM OF WALL JOINT : GYPSUM WALL ASSEMBLY

ASSEMBLY RATING = 1-HR.

L-RATING AT AMBIENT = LESS THAN 1 CFM / LIN FT

L-RATING AT 400°F = LESS THAN 1 CFM / LIN FT

CROSS-SECTIONAL VIEW

1. CONCRETE FLOOR ASSEMBLY (1-HR. FIRE-RATING) :
 - A. LIGHTWEIGHT OR NORMAL WEIGHT CONCRETE FLOOR (MINIMUM 4-1/2" THICK).
 - B. ANY UL/cUL CLASSIFIED PRECAST (HOLLOW-CORE) CONCRETE FLOOR (MINIMUM 6" THICK).
 - C. STEEL FLOOR UNIT/FLOOR ASSEMBLY - LIGHTWEIGHT OR NORMAL WEIGHT CONCRETE FLOOR (MINIMUM 2-1/2" THICK) OVER METAL DECKING.
2. GYPSUM WALL ASSEMBLY (UL/cUL CLASSIFIED U300, V300, OR W300 SERIES) (1-HR. FIRE-RATING).
 - A. WOOD PLATES AND STUDS TO CONSIST OF NOMINAL 2"X4" OR LARGER LUMBER (STUDS SPACED MAXIMUM 16" OC).
 - B. (OPTIONAL, NOT SHOWN) ANY GLASS FIBER INSULATION BEARING THE UL CLASSIFICATION MARKING AS TO FIRE RESISTANCE OR SURFACE BURNING CHARACTERISTICS, OF A WIDTH AND THICKNESS TO COMPLETELY FILL STUD CAVITY. INSULATION BATTS FRICTION FIT TO COMPLETELY FILL ALL STUD CAVITY.
 - C. ONE LAYER OF NOMINAL 5/8" THICK GYPSUM WALLBOARD. TYPE, AND SHEET ORIENTATION AS SPECIFIED IN THE INDIVIDUAL UL DESIGN.
3. HILTI CFS-BTS BOTTOM TRACK SEAL (5/8") TO BE COMPRESSED AND INSERTED INTO THE JOINT AFTER GYPSUM INSTALLATION SUCH THAT THE BTS IS FLUSH WITH THE EXPOSED FACE OF THE GYPSUM. BUTT JOINTS SHALL BE COMPRESSED 1/2 IN (13MM). THE ADHESIVE'S BACKING MAY REMAIN ON THE PRODUCT.

NOTE : MAXIMUM WIDTH OF JOINT = 3/4".

**Hilti Firestop Systems**

HILTI, Inc.
Plano, Texas USA (800) 879-8000

Sheet	1 of 2
Scale	5/32" = 1"
Date	May 22, 2024

Drawing No.

BWS
0073a

Saving Lives through Innovation and Education