

## Elevator Application – Single Bracket Engineering Request Form

To provide you with the best customer and engineering services, please:

- Provide the requested Contact Information, fields 1 to 10 of page 1.
- Provide the requested information, page 2.
- E-mail the form to **US+CA.HAC@Hilti.com** or to your local Hilti Field Representative.
- Provide any additional information such as architectural and structural drawings, clip geometry, additional sketches, etc. that may help to clarify and optimize the HAC design.

### Contact Information

1. Company Name:
2. Project Name:
3. Project City:  4.State:
5. Contact Person:
6. Phone Number:
7. Email Address:
8. Date Engineering Solution Required:
9. Bid Date (if applicable):
10. SAP Account (if applicable):

## Superior Performance

### Cost Savings

Reduced edge distance which allows the use of smaller clips

### Optimized Geometry

Innovative V-form that generates a greater concrete cone

### Time Savings

LDPE closed-cell foam filling provides a tear-out strip

### Well Sealed System

Plastic end caps that help keeping concrete slurry out of the channels

Hilti  
5400 S. 122nd E. Ave. | Tulsa, OK 74146  
Phone: 1-800-879-8000 | Fax: 1-800-879-7000  
Email: [US+CA.HAC@Hilti.com](mailto:US+CA.HAC@Hilti.com)  
[www.us.hilti.com/hac-anchor-channel](http://www.us.hilti.com/hac-anchor-channel)

© 2014 HILTI

## Elevator Application – Single Bracket Engineering Request Form

Project Name:

Condition No.:  Detail No.:

- **Provided loads are design loads**
- **Load eccentricities are based on worst condition**

### Load Combinations

1)  +  +

2)  +  +

3)  +  +

4)  +  +

5)  +  +

### Materials

- Concrete Strength,  $f'_c$ :  psi
- Lightweight Concrete:
- Density of Concrete,  $\rho$ :  pcf
- Reinforcement Type:
- Cracked concrete:

### Geometry

- Number of bolts per bracket:
- Spacing of T-bolts,  $S_b$ :  in
- Center of bracket to bottom,  $e_b$ :  in
- Center of bracket to top,  $e_t$ :  in
- Thickness of bracket:  in

### Additional comments:

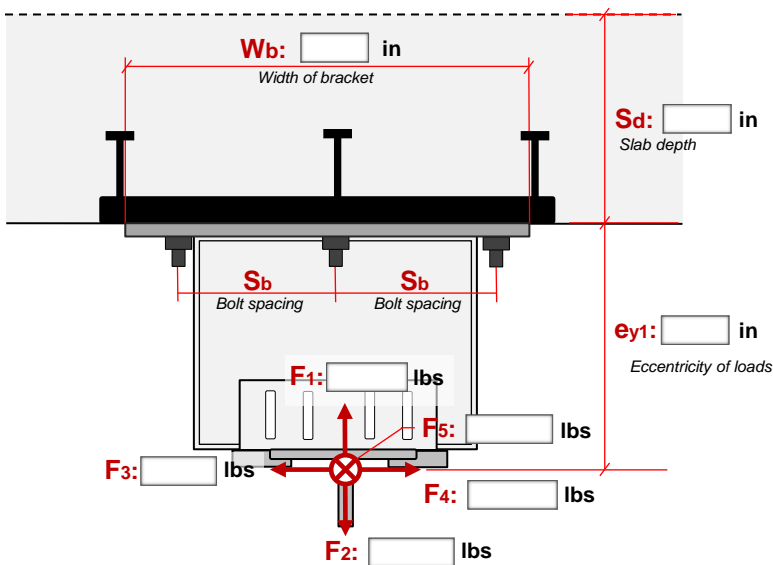

Figure 1.0 Plan View

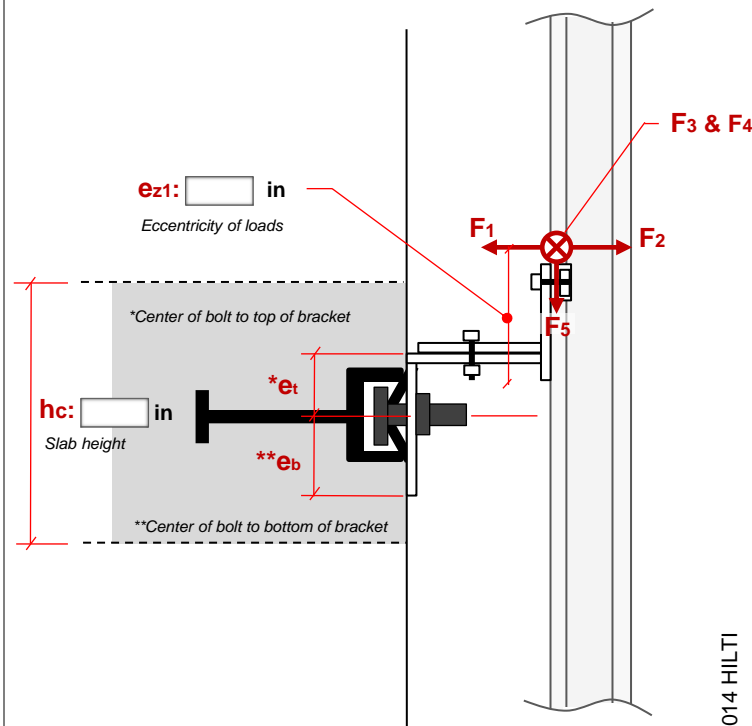

Figure 2.0 Typical Section