

Elevator Application – Combined Brackets Engineering Request Form

To provide you with the best customer and engineering services, please:

- Provide the requested Contact Information, fields 1 to 10 of page 1.
- Provide the requested information, page 2.
- E-mail the form to **US+CA.HAC@Hilti.com** or to your local Hilti Field Representative.
- Provide any additional information such as architectural and structural drawings, clip geometry, additional sketches, etc. that may help to clarify and optimize the HAC design.

Contact Information

1. Company Name:
2. Project Name:
3. Project City: 4.State:
5. Contact Person:
6. Phone Number:
7. Email Address:
8. Date Engineering Solution Required:
9. Bid Date (if applicable):
10. SAP Account (if applicable):

Superior Performance

Cost Savings

Reduced edge distance which allows the use of smaller clips

Optimized Geometry

Innovative V-form that generates a greater concrete cone

Time Savings

LDPE closed-cell foam filling provides a tear-out strip

Well Sealed System

Plastic end caps that help keeping concrete slurry out of the channels

Hilti
5400 S. 122nd E. Ave. | Tulsa, OK 74146
Phone: 1-800-879-8000 | Fax: 1-800-879-7000
Email: US+CA.HAC@Hilti.com
www.us.hilti.com/hac-anchor-channel

© 2014 HILTI

Elevator Application – Combined Brackets Engineering Request Form

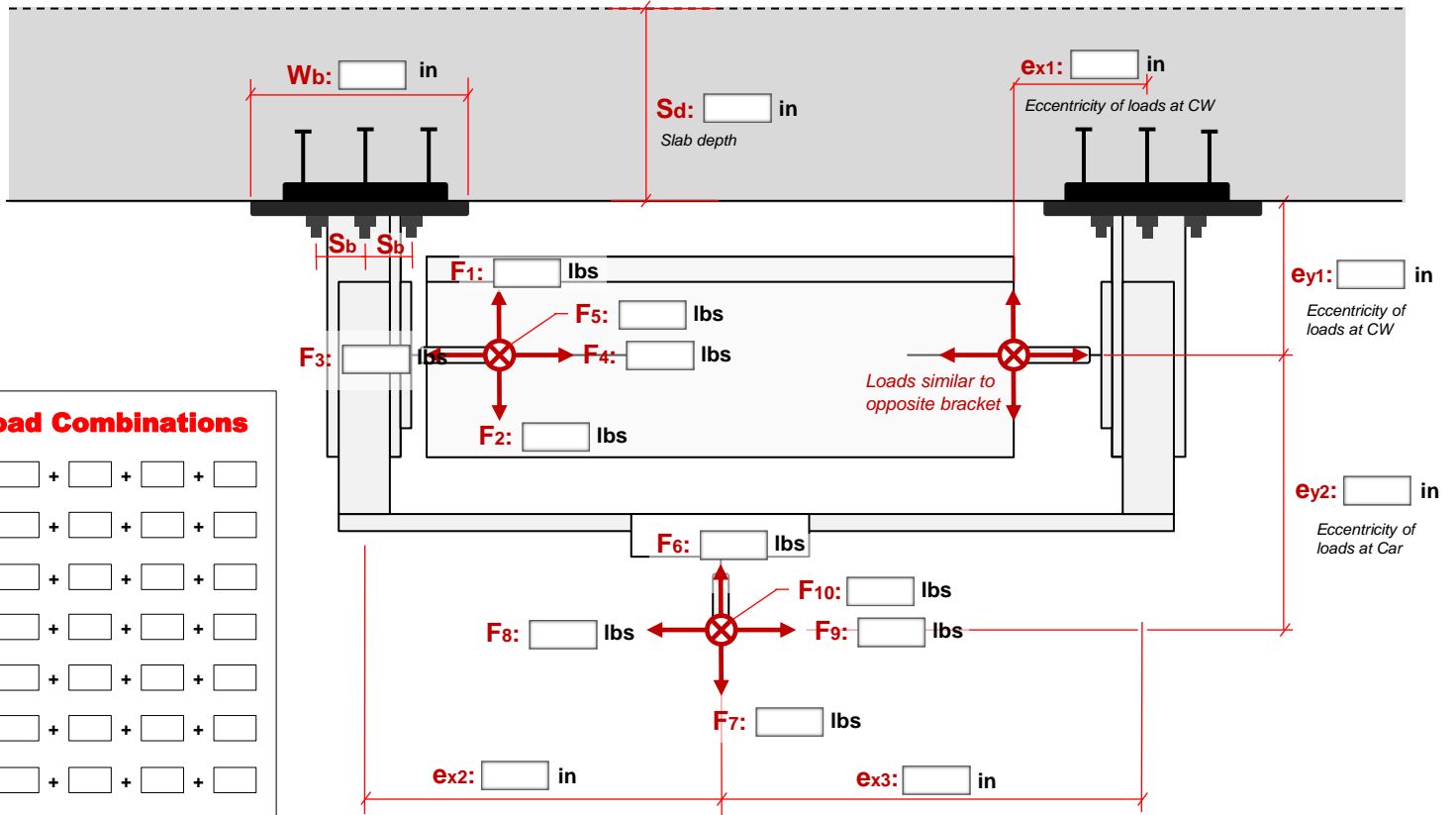

Load Combinations

- 1) + + +
- 2) + + +
- 3) + + +
- 4) + + +
- 5) + + +
- 6) + + +
- 7) + + +
- 8) + + +

Figure 1.0 Plan View

Project Name:

Condition No.: Detail No.:

- **Provided loads are design loads**
- **Load eccentricities are based on worst condition**

Materials

1. Concrete Strength, f'_c : psi
2. Lightweight Concrete:
3. Density of Concrete, ρ : pcf
4. Reinforcement Type:
5. Cracked concrete:

Geometry

8. Number of bolts per bracket:
9. Sb: in
10. hb: in
11. Thickness of bracket: in

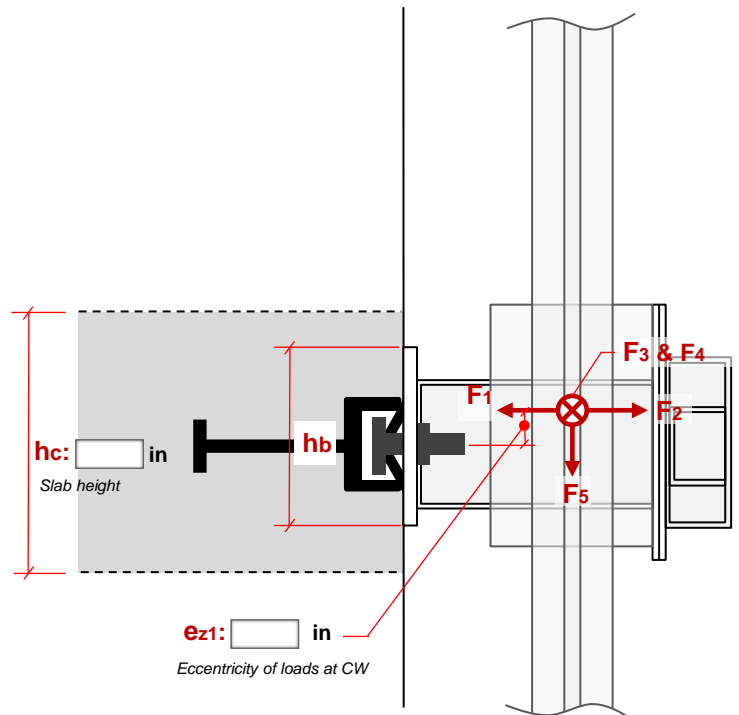

Figure 2.0 Typical Section